

**Conference Room A & B**

- Natural Daylight
- Blackout facilities
- Direct Dial Telephone
- Sound Proof
- Clock
- Adjustable lighting
- TV & Video access
- Wireless Internet Access
- Built in Screen
- Wheelchair Access
- Lectern

**Boardroom 1, 2 & 3**

- Natural Daylight
- Black out facilities
- Direct Dial Telephone
- Sound Proof
- Clock
- Overhead Projector
- TV & Video Access
- Wireless Internet Access
- Built in Screen
- Wheelchair Access
- Lectern

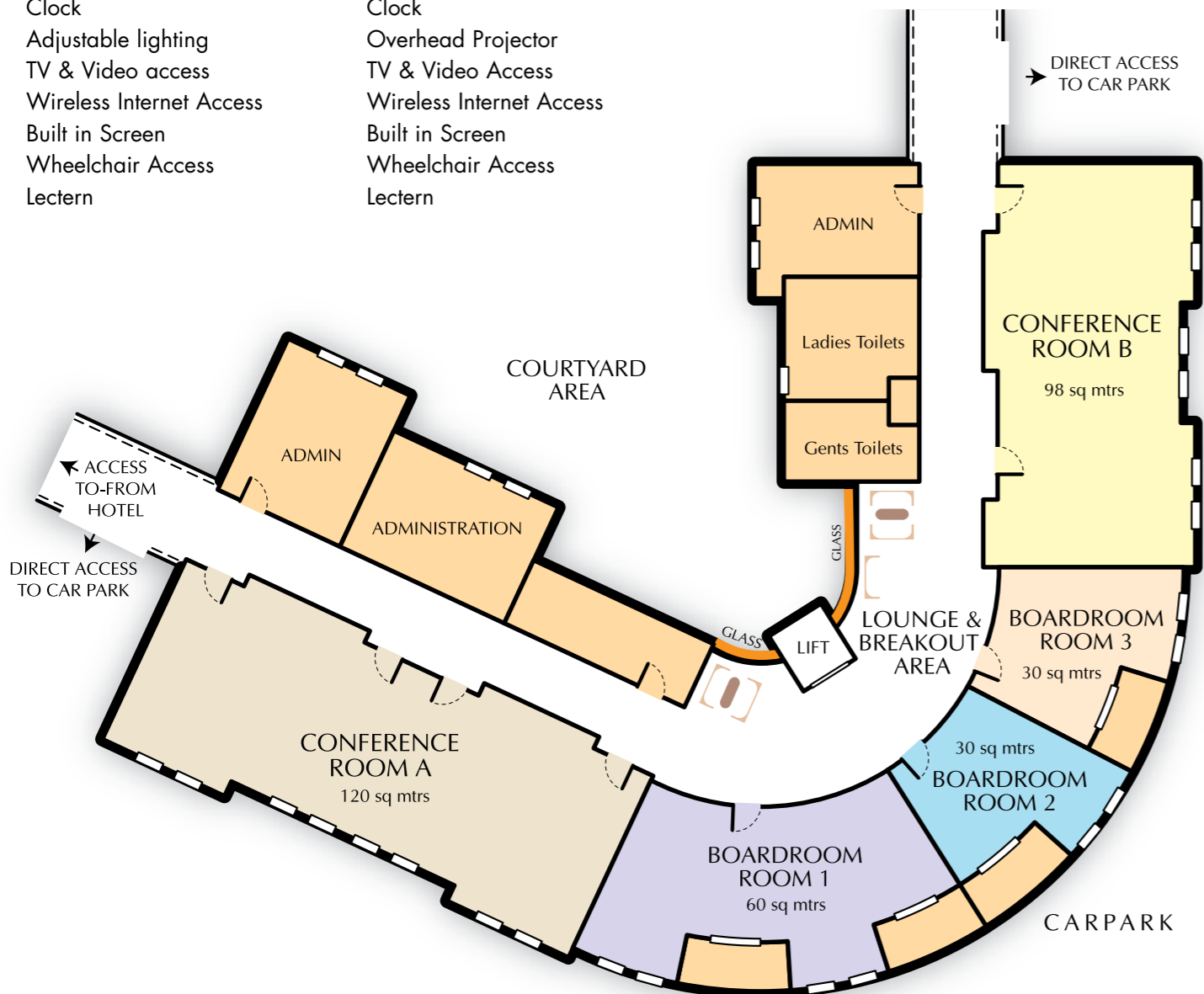

**A Prime Destination in the Corporate World . . .**

Located in the scenic Dublin - Wicklow border,  
on the doorstep to Dublin City centre

**Ramada Hotel & Conference Centre**

Southern Cross Road, Bray, Co. Wicklow, Ireland.  
t: +353 (0)1 276 0258 f: +353 (0)1 276 0298

[www.ramadabray.com](http://www.ramadabray.com)

Enquiries for Corporate, Conference and Meetings - e: [meetings@ramadabray.com](mailto:meetings@ramadabray.com)



**“Attention to detail will ensure success”**



### **Executive Wing & Conference Centre**

The modern open plan design in the Conference Centre sets the tone for your business day. Each meeting room is tastefully designed with natural day light throughout.

There is a separate lounge area where delegates can gather for breakouts and refreshments. All five meeting rooms are on the ground floor furnished with today's necessary state of the art presentation aids.

Direct access from the Conference Centre to ample car parking is in place for convenience.



The superbly appointed en-suite bedrooms are spacious and tastefully designed with all the extra amenities to ensure your stay is one of comfort and relaxation.



### **Airport Shuttle and Business Services**

Business services including photocopying and faxes are on hand with free internet access available throughout the hotel. Express shuttle service direct to Dublin International Airport is available from the front of the hotel.



### **Location and Activities**

Located at the renowned gateway to the Garden of Ireland, surrounded by golf courses, national historical attractions, Powerscourt Gardens and Waterfalls, 1 km from the beach seafront, fishing and horse riding. Irish souvenir shops such as Avoca Handweavers are nearby. Traditional Irish music and food can be found at the famous Johnnie Fox's Pub only 15 minutes away, or shop in Europe's largest outlet centre, Dundrum Shopping Centre.



### **Executive Rooms**

The executive bedrooms offer a fabulous view over Bray Golf course with some rooms offering a private external door and patio. When staying in the executive rooms you are supplied the additional luxury of your own personal towelling bathrobe, & slippers, crisp cotton duvet, daily newspaper and the convenience of express checkout.

*“Cleanliness, Style & Comfort,  
all under one blanket”*

### **Bar & Restaurant**

The lounge offers the perfect place to relax and unwind after your day of business with comfortable seating, full bar services and a lite-fare menu served daily. Or adjourn in the Parklands restaurant for a gourmet dinner. There is a fine selection of contemporary, healthy option and traditional menus to choose from.



**Free Car Parking**

**[www.ramadabray.com](http://www.ramadabray.com)**